

ITU - ISTANBUL TECHNICAL UNIVERSITY
Istanbul – Turkey
FACULTY OF ARCHITECTURE
DEPARTMENT OF ARCHITECTURE

ANNUAL REPORT 2012 for NAAB

Bachelor of Architecture (4 years)
and
Master of Architecture (2 years)

Table of Contents

- A. Program's response to each condition identified as not met in the *VTR*
- B. Program's response to each the causes of concern listed in the *VTR*.
- C. Brief summary of changes, that have been made or may be in the accredited program.
- D. *Annual Report* statistics.

ITU - ISTANBUL TECHNICAL UNIVERSITY – Istanbul Turkey
FACULTY OF ARCHITECTURE
DEPARTMENT OF ARCHITECTURE

Bachelor of Architecture (4 years)
and
Master of Architecture (2 years)

Program Head
Prof. Arzu ERDEM, Ph.D.

ANNUAL REPORT 2011 for NAAB

Prepared by ITU Department of Architecture Accreditation Committee and ITU Department of Architecture NAAB Advisory Board

Table of Contents

- A. Program's response to each condition identified as not met in the *VTR*
- B. Program's response to each the causes of concern listed in the *VTR*.
- C. Brief summary of changes, that have been made or may be in the accredited program.
- D. *Annual Report* statistics.

Accreditation Advisor	Self Assessment Team
Prof. Orhan HACIHASANOĞLU Ph.D.	Assoc. Prof. Nurbin PAKER KAHVECİOĞLU Ph.D.
	Assist. Prof. Aslihan ŞENEL Ph.D.
	Prof. Belkıs ULUOĞLU Ph.D.

A. PROGRAM'S RESPONSE TO EACH CONDITION IDENTIFIED AS NOT MET IN THE VISITING TEAM REPORT

There was not any deficiency in the most recent Visiting Team Report written in 2007 for undergraduate 4 years architecture program and 2 years Master of Architecture Program.

B. PROGRAM'S RESPONSE TO EACH THE CAUSES OF CONCERN LISTED IN THE VISITING TEAM REPORT.

1. 8. Physical Resources

Its designation as a historic structure places limitations on adaptation of existing spaces for alternative use and its age and historic-structure designation suggest to the team that modifications to make all spaces accessible to the physically disabled would be difficult and expensive. (Most recent VTR)

The Deanship of Faculty of Architecture found resource for five stair-lifts and two lifts (south-east corner lift and northwest corner lift) to solve the accessibility problems of first and second floors. New five stair – lifts were started to use and the renovation of 2 lifts finished in 2012. See the photographs of stair-lifts and the renovated lift.



Photograph of one stair-lift

C. BRIEF SUMMARY OF CHANGES, THAT HAS BEEN MADE OR MAY BE IN THE ACCREDITED PROGRAM.

1.3 Architectural Education and Registration

A draft of “Law of Profession for Architects” designed and submitted to government representatives in 2007. The state clerks of Ministry of Work and Social Security now work on this draft. It is expected that till 2010 this law will be running in Turkey. The draft law covers the following registration requirements for architects.

1. Minimum 5 (there are; 5, 3+2, 4+2 years alternatives in debate) years full time architectural education. (It is 4 years now in Turkey),
2. 52 weeks professional internship in offices and construction sites,
3. Acceptance for registration by Registration Board (It was organized by Chamber of Architects, however application to registration board is not compulsory to make professional work).

Architecture (undergraduate and graduate) programs of ITU are ready for 4+2 years alternative. Also architecture program can easily adapt its existing curriculum to other alternatives.

1.4 Architectural Education and the Profession

There is not any change after most recent VTR

12. Professional Degrees and Curriculum

Graduate programs supported by ITU Department of Architecture had been revised by the department and programs according to decision of Graduate School of Science, Engineering and Technology starting from 2011 and finished in 2012. This procedure is called Continuing Quality Development System for Graduate Programs and covered all graduate programs in ITU. Therefore Master of Architecture Program also prepared course catalog forms, revised the contents of courses, credits and students’ loads according to Bologna Procedures of European Higher Education Area System. The main work realized on the students’ working loads and a Course Working Load Sheets had been prepared by each course in graduate programs.

The Administration and Staff

Dean Orhan HACIHASANOĞLU (Nov. 2011 - August 2012) – Interim Dean Gülen ÇAĞDAŞ (August 2012 -)

The Dean is the chief executive officer and representative of the legal personality of the Faculty. The main responsibilities of the Dean are;

- To manage faculty board meetings and to control carrying out of faculty board’s decisions,
- To manage inter-relation between faculty units,
- To control educational activities,
- To direct and coordinate financial activities,
- To control academics and staff,

The dean has no teaching responsibility. However, s/he usually prefers to give courses.

Associate Deans Nilgün ERGUN and Yegan KAHYA (November 2011- August 2012) Interim Associate Deans Elçin TAŞ – Çağatay SEÇKİN (August 2012 -)

Associate Deans assist the Dean in carrying out all the administrative work. The teaching responsibility of the Associate Dean is minimum of 5 hours/week.

Associate Dean Yegan KAHYA (November 2011- August 2012) and Interim Associate Dean Çağatay SEÇKİN (August 2012 -) are responsible in;

- Planning and organizing of space facilities, equipment and personnel,
- Project development,
- Financial and purchasing works,
- Organizing and coordinating cleaning and construction works,
- Organizing and controlling security and emergency related issues,
- Organizing and coordinating technology related issues such as data show, computer purchasing, LAN construction and maintaining,
- Organizing personnel development facilities such as first aid courses,
- Other administrative duties.

Associate Dean Nilgün ERGUN (November 2011- August 2012) and Interim Associate Dean Elçin TAŞ (August 2012 -) are responsible in;

- Coordinating issues related with student affairs,
- Controlling issues related with education and ensuring proper application of ITU undergraduate regulations,
- Organizing and coordinating students' social activities and clubs,
- Ensuring proper application of course plans,
- Preparing and coordinating lecture and exam time-tables,
- Coordinating issues related with student exchange between different majors,
- Coordinating issues related with double-major programs,
- Coordinating lecture-rooms and studios assignments,
- Organizing and coordinating faculty-wide social activities,
- Other administrative duties.

Chair of Department of Architecture: Arzu ERDEM

The Department Chair is responsible in organizing efficiently execution of the research and educational activities of the academics and department staff. The teaching responsibility of the Department Head is minimum of 5 hours/week.

Associate Chair of Department of Architecture: Nurbin PAKER KAHVECİOĞLU and Ashhan ŞENEL

Associate Heads assist Department Head in carrying out all the administrative work of the department.

Department Administrative Secretaries: Çiğdem MEYDAN and Esra BALCI

Manage all written and oral administrative relation between the Department and academics, branches, faculty, and institutes.

Library Staff

- Specialist Sevil ÖZKAN
- Specialist (Periodicals) Murat AYATAÇ
- Librarian Selma CİN
- Librarian (Periodicals) Ayhan ÇITLAK

Student Affairs Office Staff

- Nurten TOKATLI
- Yusuf YETKİN
- Aytekin ATAŞ

Computer Centre

- Instructor Atilla AYDOĞDU (network administrator)
- Specialist Gültekin PULAT (network administrator)
- Technicians Azat YAŞAR and Vahap GÜRBÜZ

Building Materials Laboratory

Technician İbrahim ÖZTÜRK

Copy Centre

Technician Harun CEYLAN

Photography and Visual Arts Laboratory

Specialist Aras NEFTÇİ, Ph.D.

LABORATORY

Building Material Laboratory

The Building Materials Laboratory in the Department of Architecture of ITU was founded in 1968 primarily to support the education by the facilities that help to realize research and development in the area of building materials in architecture. The research areas are focused on developing new materials based significantly on local resources, improving the quality of existing building materials and characterizing the existing and/or historical materials.

Physical, Mechanical, Technological and the Chemical properties of the building materials can be determined. The Laboratory provides research opportunities for undergraduate, graduate students as well as academic researchers of our university. The laboratory has a main laboratory section and a classroom space.

Building Material Laboratory II

The Building Material Laboratory, completed in 2006, was established for research on building materials in historic buildings and is used by both undergraduate and graduate students. Characterization of the buildings materials in historic buildings, examining of samples from the buildings for the aim of determining the problems and working up on proposals for restoration and conservation projects are the main purposes of this laboratory. For this research field there are different equipments for experiments like; fume cupboard, drying oven, ash stove, centrifugal machine, thermogravimeter, magnetic mixer with heater, scales, conductance measured, pH meter, trinocular microscopes, stoning machine, pure water producer and ultrasonic tab.

Wind Tunnel Unit

The studies related to the wind are realized in Istanbul Technical University, Physical Environment Control Laboratory by the support of I.T.U. Mechanical Engineering Faculty equipment and staff. The tunnel in I.T.U Faculty of Architecture Physical Environmental Control Laboratory is an open returning-closed jet Eiffel type, sub sonic and also a suction type tunnel.

Acoustics Unit

Acoustics unit of Physical Environmental Control Laboratory had acoustic test rooms. The test rooms give opportunities for the following measurements: (1) sound insulation measurements for building elements against airborne sound; (2) sound insulation measurements for new constructions if the existing building element is not sufficient for sound insulation after measurements; (3) sound transmission measurements for doors and windows to improve their performance and develop new types of doors and windows. The following measurement types can be realized by acoustical unit in the field studies: (1) environmental noise measurements (traffic, airport, railroad, industry, etc.); (2) sound transmission loss measurements for building elements; (3) reverberation time measurements for closed spaces (auditorium, concert hall, meeting room, etc.). Acoustical unit test rooms consist of two test rooms.

Climatization Unit

This laboratory has been established in Faculty of Architecture for climatic and thermal comfort measurements in order to evaluate existing buildings. The laboratory is used for educational purposes, researches and professional consultant works and it covers the following instruments. The Indoor Climate Analyzer has widespread applications in the heating and air-conditioning fields. The Analyzer can be used to help in the provision of more acceptable working conditions. Using the Analyzer, measurements can be conducted to see if an existing environment is satisfactory, or to determine the type and size of any improvements to heating and air conditioning plant that are required. It can also be used to investigate complaints from staff and provide quantitative data to help overcome the problems encountered. It has different probes for air temperature, humidity, air velocity, radiant temperature and surface temperature measurements.

Lighting Unit

This laboratory is open for access of all graduate and undergraduate programs' students. Aim of the unit is to measure the magnitudes of illuminative sources. For this purpose our faculty owns luxmeter, photometer and different types of light sources related with the artificial illumination.

Sanitary Installation Unit

This laboratory was equipped for analysis based information practice with samples and models for health care equipment and application boards for grey-water and fresh-water discharge systems.

MODEL WORKSHOP

The Model Workshop, completed in 2007, was established for usage of both undergraduate and graduate students.

This workshop has equipments like, circular saw, t-square machine, fret-saw, belt-saw, 100lt compressor, hammer drill, different types of pliers, paint spraying pistol, carborundum pistol, and different types of graters. This workshop established with the donations of ITU Architectural Faculty graduates.

A 3D prototyping machine and 1 laser cutter and 1 3D CNC cutter with their support computers and other equipment had been added to model workshops of the school at 2011. The Computer Aided Model Workshop has special regulations for undergraduate and graduate students.

9. Information Resources

ARCHIVES:

Faculty of Architecture Archive

Faculty of Architecture Archive was established in 2003. Administrative documents, graduation projects, photographs, films, books published by Faculty of Architecture, catalogs of past academic years, student cards that were used for architectural design studios documentation, dissertation thesis, special archives of emeritus professors, Archive of Sedat Çetintaş which contains special drawings of historical monuments, are archived in this space.

Kubilay ÖNAL who was assigned as the responsible person form archive worked with two student assistants for reorganizing the archive documents.

Restoration Archive

Restoration Archive had many historical site plans and restoration projects realized by faculty members and students. This archive also cataloged some digital maps of Istanbul.

***GaleriTAŞKIŞLA* Museum of ITU Faculty of Architecture**

The initiation of collecting materials about the history of ITU Faculty of Architecture started in 2009. *GaleriTAŞKIŞLA* Museum of ITU Faculty of Architecture was open to continuous exhibitions in the halls of the building in 2012. The exhibitions cover:

1. People in the history of Faculty of Architecture.



Mimar **KEMALETTİN BEY**
(D.1872-Ö.1927)

Hendese-i Mülkiye Mektebi
(1891-7)
(Hendese-i Mülkiye Mektebi
Mezunu 1891)



Prof. Paul **BONATZ**
(D.1877-Ö.1956)

Mimarlık Fakültesi Bina Bilgisi
Kürsüsü



Prof. Paolo **VERZONE**
(D.1902-Ö.1986)

Mimarlık Fakültesi
(1951-1959)
(İnşaat Mühendisi-Politecnico di
Torino 1925 mezunu)



Ord. Prof. Wilhelm **TIEDJE**
(D.1898 - Ö.1967)

İTÜ Mimarlık Fakültesi
(1952-1953)
(1922 Hannover Teknik Üniversitesi
Mezunu)

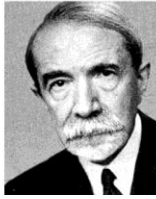

Ord. Prof. Dr. Gustav
OELSNER
(D.1879 - Ö.1956)

Mimar Şubesi Şehirçilik Kürsüsü
(1939)
(Berlin Teknik Üniversitesi Mimarlık
mezunu)



Prof. Rudolf **BELLING**
(D.1886 - Ö.1972)

Mimarlık Fakültesi
(1951-1966)



Prof. Clemens
HOLZMEISTER
(D.1886 - Ö.1983)

Mimarlık Fakültesi 1940-1949
(1913 Vyana Teknik Üniversitesi
Mimarlık mezunu)



Prof. Hamit **DİLGAN**
(D.1901 - Ö. 1976)

İTÜ Mimarlık Fakültesi Yüksek
Matematik Kürsüsü
(1932-1970)
(1924 İ.U. Matematik Fizik Mezunu)



Prof. Mukbil **GÖKDOĞAN**
(D.1908-Ö.1992)

Mimarlık Fakültesi
Yapı Bilgisi Kürsüsü (1946-1969)



Ord. Prof. Emin **ONAT**
(D.1908-Ö.1961)

Mimarlık Fakültesi
Bina Bilgisi Kürsüsü (1935-1961)
(1934 Zürih Teknik Üniversitesi
mezunu)



Prof. Orhan **ARDA**
(D.1911-Ö.2003)

Mimarlık Fakültesi Bina Bilgisi II,
Endüstrileşmiş Bina ve Çevre Analizi
Kürsüsü, (1938-1978)
(1936 İTÜ Mimar Şubesi mezunu)



Prof. Said **KURAN**
(D.1911 - Ö.1998)

İTÜ Mimarlık Fakültesi Yapı Statik ve
Betonarme Kürsüsü
(1946-1976)
(1933 Yüksek Mühendis Mektebi
İnşaat Şubesi mezunu)

İTÜ Mimarlık Fakültesi tarihinde öğretim üyeleri
Faculty members in the history of İTÜ Faculty of Architecture

galeriTAŞKIŞLA

2. Materials used in the history for teaching, learning, drawing and administration.
3. Archive of Sedat Çetintaş which contains special drawings of historical monuments,



4. Art pieces including paintings, sculpture and a wall painting.
5. List and photographs of all graduates. (only in website)



GaleriTAŞKIŞLA has also a web site. Its url is: <http://www.mim.itu.edu.tr/galeritaskisla/index.htm>

galeriTAŞKIŞLA

İSTANBUL TEKNİK ÜNİVERSİTESİ MİMARLIK FAKÜLTESİ SÜREKLİ VE GEÇİCİ SERGİLERİ

MEKANLAR	SERGİLER	ARŞİV	TASKISLA SANAT	ANA SAYFA
102 sergi salonu	S. Çelintaş Rölöveleri	2008 sergileri	Taşkışla sanatçıları	galeriTAŞKIŞLA_broşür
Habitat salonu	Öğretim Üyeleri	2009 sergileri	Taşkışla sanat eserleri	
Sinan holü		Divriđi Ulucami sergisi	Yapı bileşenleri	
Rektörlük holü				
109 holü				
127 holü				

İstanbul Teknik Üniversitesi Mimarlık Fakültesi Taşkışla Binası geniş koridorları yüksek tavanları ile çeşitli ve alternatif sergileme olanakları sağlayan tarihi bir yapıdır. İTÜ Mimarlık Fakültesi'nin geçmişine yönelik sürekli sergiler Taşkışla'nın çeşitli mekanlarında yer almaktadır.

galeriTAŞKIŞLA'da geçici sergi açma önerileri için aşağıdaki faks numarasına veya adrese yazılı olarak başvurulmalıdır.



İletişim: galeriTAŞKIŞLA | İTÜ Mimarlık Fakültesi Taşkışla Caddesi Takım 34437 İstanbul | Tel: 0212 2452753 | Faks: 0212 2514895

GaleriTAŞKIŞLA web site.

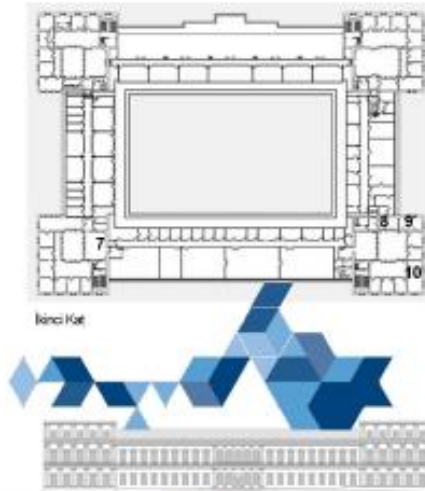

7 Sedat BİZEYİŞ Taşkişla Güzel Sanatlar Bölümü Hali



8 Ercüment KALMIK Tarihî binemiyor Taşkişla 330



9 Emin Onet Ercüment KALMIK 1951 Delanlık Odası



Bedri Rahmi EYÜBOĞLU 1948 Delanlık Odası



10 Ercüment KALMIK 1950 326

Istanbul Teknik Üniversitesi Mimarlık Fakültesi galeriTAŞKIŞLA

İletişim: galeriTAŞKIŞLA | İTÜ Mimarlık Fakültesi Taşkişla Caddesi Taksim 34437 İstanbul | Tel: 0212 2452753 | Faks: 0212 2514895



<http://www.mim.itu.edu.tr/galeritaskisla/>

Istanbul Teknik Üniversitesi Mimarlık Fakültesi Taşkişla Binası geniş koridorları yüksek tavanları ile çeşitli ve alternatif sergileme olanakları sağlayan tarihi bir yapıdır. İTÜ Mimarlık Fakültesi'nin geçmişine yönelik sürekli sergiler Taşkişla'nın çeşitli mekanlarında yer almaktadır. galeriTAŞKIŞLA İTÜ Mimarlık Fakültesi müzesidir.

102 sergi salonu: 157.7 m2,tavan yüksekliği 7.36 metredir.
Habitat salonu: 510 m2 tavan yüksekliği 5.40 metredir.
Sinan hali: Mimar Sinan büstünün bulunduğu holdir. 225 m2 kullanım alanı bulunmaktadır. Tavan yüksekliği 7.36 metredir.
Rektörlük hali: 225 m2 tavan yüksekliği 7.36 metredir.
109 Hali: Prof.Nezah Eidem Salonu fuayesidir. 225 m2
127 Hali: Prof. Kemal Ahmet Arı Salonu fuayesidir. 225 m2



TAŞKIŞLA

İngiliz mimar Williams James Smith ve yardımcısı Osmanlı kalfa İsmail tarafından 1848 ve 1852 arasında, Nak-ıh-İTıbbiye-i Şahane (Askeri Tıbbiye) için hastane olarak yapıldı. Kırım Savaşı (1853-56) sırasında Osmanlıların müttefik Fransızların yarattığı burada tedavi edildik. Savaşın sonuna kadar uzun süre boy kaldığı için harap olan yapı 1950'lerden itibaren restore edilerek kullanılmaya başlandı. 31 Mart Olayı sırasında içinde kalan Asya Taburu askerleriyle Hareket Ordusu birliği arasında çatışmalara sahne oldu. Cumhuriyetten sonra Maarif Vekâlet'i ne verildi. 1943-50 arasında büyük bir onarımdan geçirilip yeniden düzenlenen yapıya İTÜ Rektörlüğü ile Mimarlık ve İnşaat fakülteleri yerleştirildi (1950). 1983'te Gayrimenkul Eski Eserler ve Anıtlar Yüksek Kurulu tarafından aynı koruması gerekli 1. sınıf tarihsel anıt olduğu karar alındı.

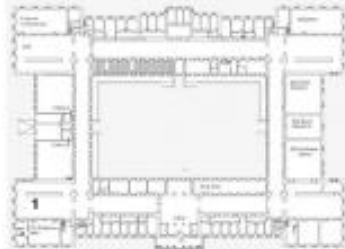

Zemin Kat

1 Duvar panosu
Nurulah Berk, Abdurrahman Özdoğrak,



2

Sedat Çeltiçtaş Röleveleri Sürekli Sergisi
Mimar Sedat Çeltiçtaş Tünel'in çeşitli yönlerinde tarihi binalara ait röleveleri İTÜ Mimarlık Fakültesi arşivinde yer almaktadır. Röleveler Taşkişla 222 nolu Salonu Salonu'nda sürekli olarak sergilenmektedir.

3 Araç ve giysiler sergisi
İTÜ Mimarlık Fakültesi'nde çeşitli dönemlerde kullanılmaya başlanan ve giysiler Sinan Hali'nde vitrinlerde sergilenmektedir.

4 İTÜ Mimarlık Fakültesi Mezunları
İTÜ Mimarlık Fakültesi mezunları ekranlarda fotoğrafları ile sunulmaktadır.



6 İTÜ Mimarlık Fakültesi Tarihinde Öğretim Üyeleri Sürekli Sergisi
İTÜ Mimarlık Fakültesinde geçmişte çalışmış olan emekli olmuş veya çalışmakta iken hayatını kaybetmiş öğretim üyeleri ve öğretim görevlerini tanıtan sergidir. (Sinan Hali)



Mimar Sinan Büstü
Can Egeci - 1990

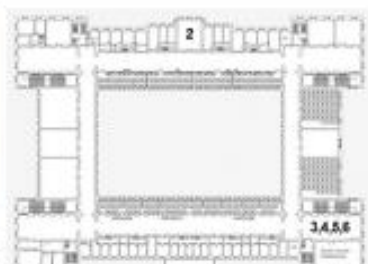

Birinci kat

LIBRARY

In 2007, Central Library (Mustafa İnan Library) was moved from its temporary building to its new building constructed near Students' Hall and Sports Hall in the main campus of the university. The Central Library is now open 24 hours in 7 days of the week with some parts. The whole sections of the Central Library will be opened to student use as 24 hours and 7 days of week in the following weeks.

There are also the faculty libraries in the faculties of Mechanical Engineering (Gümüşsuyu), Architecture (Taşkışla), Management (Maçka), and Maritime (Tuzla), the Turkish Music State Conservatory, the Department of Languages and History of Atatürk Reforms (Maçka) and the Department of Fine Arts (Taşkışla). ITU libraries have approximately 223.438 volumes of books, and also 50.000 e-books. The number of subscribed periodicals is 15.515 (751 printed, 14.764 on-line). The ITU libraries work on an open shelf basis. There is an interlibrary loan and a supply of periodicals service. The monthly lists of newly bought books and the subscribed periodicals can be found at <http://www.library.itu.edu.tr>.

Administrative Structure

In 2009 Istanbul Technical University Senate decided that all units which were organized under the departmental organization of the university will be unified. A basic academic faculty unit will organize in every undergraduate department in the university. According to this regulation of university senate 4 existing academic faculty organization units of Department of Architecture were closed and a new Academic Faculty Unit of Architecture was inaugurated. The specialization of faculty members in Appendix 2 is listed according to old academic units of the department.

D. ANNUAL REPORT STATISTICS

NAAB STATISTICAL REPORT

Istanbul Technical University / Faculty of Architecture

Completed by: October , 2012

ACSA region:

State University

STUDENT DATA

	4 year PreProf	M.Arch PostNonProf
Full-Time Students	869	35
Part-Time Students	-	-
FTE Students	-	-
Arch Design Studio Students	869	35
Students Working Part-Time	-	-
Outside Stud. Serv. by Dept.	82	-
African American Students	NA	
Native American Students	NA	
Asian/Pacific Students	NA	
Hispanic Origin Students	NA	
Women Students	567	19
Foreign Students	35	-
Total Degrees Awarded	151	14
Grads. Fin. Estab. No. Yrs.	151	
Degrees Awarded Women	107	10
Degrees Awarded Afri-American	NA	
Degrees Awarded Amer. Ind.	NA	
Degrees Awarded Asi/Pac. Isl.	NA	
Degrees Awarded Hispanics	NA	
Min Req. Sat/Act/Gre Score	NA	
Number Of Applicants	NA	29
Number Accepted	140	15
Enrollment Target/Goal	140 (for 2010)	20
Student Studio/Faculty Ratio	811/ 92 (not included RA)= 8,81 811 / 133 (included RA) = 6.09	25/3=8.33

NAAB STATISTICAL REPORT

Istanbul Technical University / Faculty of Architecture
Completed by: October, 2012

FACILITY / RESOURCE DATA

Departmental Library LCNA or 720-729 Collection	4967
Total Architecture Collection in Departmental Library	9987
University Library LCNA or 720-729 Collection	2279
Total Architecture Collection in University Library	33989
Departmental Library Architecture Slides*	-
University Library Architecture Slides	-
Departmental Library Architecture Videos	189
Staff in Dept. Library	4 (between 6.-10 pm., another staff from university library is commissioned at faculty library)
Number of Computer Stations	139
Amount Spent on Information Technology	\$ 80.000 (at university)
Annual Budget For Library Resources **	\$ 42.421.33 (at faculty) \$ 2.400.000 (at university)
Per-Capita Financial Support Received From University	\$ 8000
Private Outside Monies Received by Source	-
Studio Area (Net Sq.Ft./M2)	reserved specifically for architecture dept: 1834.3 sq.m. (also, another 316.8 sq.m. studio area is shared by another dept. at the faculty)
Total Area (Gross Sq.Ft./M2)	32.328 sq.m.

(*)Even if Architectural Faculty does not have a special archive for slides, History of Architecture and Restoration divisions do have slide archives that are also open for the usage of whole Department. There are approximately 14.000 slides at the archive of History of Architecture Division and 15.000 slides at the archive of Restoration Division.

(**)This amount of money just shows the yearly expenditure on providing books for the libraries. In addition to this, ITU has subscriptions for all scientific periodicals from the publishers like Elsevier, Springer, Blackwell, Wiley, 15540 journals of different foundations, 4000.000 electronic dissertations and more than 50.000 electronic books. Architectural Publications Index , JSTOR Arts & Sciences I-III, Web of Science Arts & Humanities Citation Index, Web of Science SSCI are the electronic databases that ITU has subscription for to be used on architecture related subjects. There is no separated budget of Architectural Faculty for the expenditures of databases and libraries. All expenditures have been providing from the same budget of the University and there are no difficulties about supplying any kind of publications of different types of interests.

NAAB STATISTICAL REPORT

Istanbul Technical University / Faculty of Architecture
Completed by: October, 2012

FULL-TIME FACULTY SALARIES

	number	minimum (\$)	average(\$)	maximum(\$)	Uni.avg. (\$)
Professor	33	2366	2480	2594	2480
Associate professor	21	1825	1841	1858	1841
Assistant professor	22	1530	1546	1563	1546
Research assistant	10	1206	1222,5	1239	1222,5
Instructor	16	1286	1302.5	1319	1302.5

FACULTY DATA

	Department total
Full-Time Faculty	133
Part-Time Faculty	NA
Full-Time Equivalent (FTE) Faculty	48
Tenured Faculty	48
Tenure-Track Positions	79
FTE Administrative Positions	8 administrative positions (Associate rector (until August 2012), dean, interim dean, associate dean, interim associate dean, chair of department architecture, 2 associate department chairs)
Faculty Engaged in Service To Comm.	18
Faculty Engaged in Service To Univ.	35
FT Faculty Who are U.S. (Turkish) Licensed Registered Architects	117
PT Faculty Who are U.S. Licensed Registered Architects	NA
Practicing Architects ****	-
FTE Graduate Tas	-
FT Faculty Avg. Contact Hrs/Wk	10/Wk
PT Faculty Avg. Contact Hrs/Wk	NA

(****)A big number of faculties are working on architectural design projects through ITU Revolving Fund (İTÜ Döner Sermayesi). As an addition to the full-time faculty of the department, each term architects and designers from the practice are

leading some design studios as guest tutors and also being invited as a jury member for the term projects and graduation projects.

NAAB STATISTICAL REPORT

Istanbul Technical University / Faculty of Architecture

Completed by: October, 2012

Number Full-Time Faculty Credentials

	Ph.D.	M.Sc.	M.Arch.
Prof.	33	33	33
Assoc. Prof.	21	21	21
Assist. Prof.	22	22	22
Research Assist.	10	40	40
Instructor	16	16	16
Specialist	1	1	

	FT	PT	Prof.	Assoc. Prof.	Assist. Prof.	Research Assist.	Instructor
African-American Faculty	NA						
Native American Faculty	NA						
Asian/Pacific Island Faculty	NA						
Hispanic Origin Faculty	NA						
Italian Faculty	1				1		
Women Faculty	79	NA	20	14	15	23	7

APPENDIX 1 Student Performance Criteria Matrix

I.T.U. FACULTY OF ARCHITECTURE DEPARTMENT OF ARCHITECTURE	1st Semester			2nd Semester			3rd Semester			4th Semester			
	18M111	18M121	18M131	18M112	18M122	18M132	18M111	18M121	18M131	18M112	18M122	18M132	
RELATION WITH THE ARCHITECTURE PROGRAM													
Knowledge and abilities offered to students by architecture program													
1. Specific competences: self- and team work, efficiency	●	●	●	●	●	●	●	●	●	●	●	●	●
2. Critical thinking: ability to analyze and evaluate information, research, and design solutions	●	●	●	●	●	●	●	●	●	●	●	●	●
3. Design process: ability to develop and execute a design process, including conceptualization, development, and realization	●	●	●	●	●	●	●	●	●	●	●	●	●
4. Communication: ability to communicate design ideas and solutions effectively	●	●	●	●	●	●	●	●	●	●	●	●	●
5. Design process: ability to develop and execute a design process, including conceptualization, development, and realization	●	●	●	●	●	●	●	●	●	●	●	●	●
6. Communication: ability to communicate design ideas and solutions effectively	●	●	●	●	●	●	●	●	●	●	●	●	●
7. Design process: ability to develop and execute a design process, including conceptualization, development, and realization	●	●	●	●	●	●	●	●	●	●	●	●	●
8. Communication: ability to communicate design ideas and solutions effectively	●	●	●	●	●	●	●	●	●	●	●	●	●
9. Design process: ability to develop and execute a design process, including conceptualization, development, and realization	●	●	●	●	●	●	●	●	●	●	●	●	●
10. Communication: ability to communicate design ideas and solutions effectively	●	●	●	●	●	●	●	●	●	●	●	●	●
11. Design process: ability to develop and execute a design process, including conceptualization, development, and realization	●	●	●	●	●	●	●	●	●	●	●	●	●
12. Communication: ability to communicate design ideas and solutions effectively	●	●	●	●	●	●	●	●	●	●	●	●	●
13. Design process: ability to develop and execute a design process, including conceptualization, development, and realization	●	●	●	●	●	●	●	●	●	●	●	●	●
14. Communication: ability to communicate design ideas and solutions effectively	●	●	●	●	●	●	●	●	●	●	●	●	●
15. Design process: ability to develop and execute a design process, including conceptualization, development, and realization	●	●	●	●	●	●	●	●	●	●	●	●	●
16. Communication: ability to communicate design ideas and solutions effectively	●	●	●	●	●	●	●	●	●	●	●	●	●
17. Design process: ability to develop and execute a design process, including conceptualization, development, and realization	●	●	●	●	●	●	●	●	●	●	●	●	●
18. Communication: ability to communicate design ideas and solutions effectively	●	●	●	●	●	●	●	●	●	●	●	●	●
19. Design process: ability to develop and execute a design process, including conceptualization, development, and realization	●	●	●	●	●	●	●	●	●	●	●	●	●
20. Communication: ability to communicate design ideas and solutions effectively	●	●	●	●	●	●	●	●	●	●	●	●	●
21. Design process: ability to develop and execute a design process, including conceptualization, development, and realization	●	●	●	●	●	●	●	●	●	●	●	●	●
22. Communication: ability to communicate design ideas and solutions effectively	●	●	●	●	●	●	●	●	●	●	●	●	●
23. Design process: ability to develop and execute a design process, including conceptualization, development, and realization	●	●	●	●	●	●	●	●	●	●	●	●	●
24. Communication: ability to communicate design ideas and solutions effectively	●	●	●	●	●	●	●	●	●	●	●	●	●
25. Design process: ability to develop and execute a design process, including conceptualization, development, and realization	●	●	●	●	●	●	●	●	●	●	●	●	●
26. Communication: ability to communicate design ideas and solutions effectively	●	●	●	●	●	●	●	●	●	●	●	●	●
27. Design process: ability to develop and execute a design process, including conceptualization, development, and realization	●	●	●	●	●	●	●	●	●	●	●	●	●
28. Communication: ability to communicate design ideas and solutions effectively	●	●	●	●	●	●	●	●	●	●	●	●	●
29. Design process: ability to develop and execute a design process, including conceptualization, development, and realization	●	●	●	●	●	●	●	●	●	●	●	●	●
30. Communication: ability to communicate design ideas and solutions effectively	●	●	●	●	●	●	●	●	●	●	●	●	●
31. Design process: ability to develop and execute a design process, including conceptualization, development, and realization	●	●	●	●	●	●	●	●	●	●	●	●	●
32. Communication: ability to communicate design ideas and solutions effectively	●	●	●	●	●	●	●	●	●	●	●	●	●
33. Design process: ability to develop and execute a design process, including conceptualization, development, and realization	●	●	●	●	●	●	●	●	●	●	●	●	●
34. Communication: ability to communicate design ideas and solutions effectively	●	●	●	●	●	●	●	●	●	●	●	●	●
35. Design process: ability to develop and execute a design process, including conceptualization, development, and realization	●	●	●	●	●	●	●	●	●	●	●	●	●

● FULLY SATISFIED

○ PARTIALLY SATISFIED

■ ELECTIVE COURSES ARE GOING TO BE SHOWN IN A DIFFERENT TABLE

▨ REQUIRED PROFESSIONAL INTERNSHIP OF 72 DAYS IN SUMMER WEEKS

APPENDIX 2 List of Academic Staff (October 2012)

*: indicates tenured faculty

+: indicates part-time faculty

P: indicates holding a professional architect license

Professors	
Zeynep AHUNBAY, Ph.D. * P	Restoration
Nihal ARIOĞLU, Ph.D. * P	Building Science
Semra AYDINLI, Ph.D. * P	Architectural Design
Gülen ÇAĞDAŞ, Ph.D. * P	Architectural Design
Oğuz Cem ÇELİK, Ph.D. *	Building Science
Feridun ÇILI, Ph.D. *	Building Science
Atilla DİKBAŞ, Ph.D. * P	Building Science
Arzu ERDEM, Ph.D. * P	Architectural Design
K. Kutgün EYÜPGİLLER, Ph.D. * P	Restoration
Heyecan GİRİTLİ, Ph.D. * P	Building Science
Işıl HACIHASANOĞLU, Ph.D. * P	Architectural Design
Orhan HACIHASANOĞLU, Ph.D. * P	Architectural Design
Arda İNCEOĞLU, Ph.D. * P	Architectural Design
Özkan İŞLER, Ph.D. *	Building Science
Alaattin KANOĞLU, Ph.D. * P	Building Science
İlknur KOLAY, Ph.D. * P	Architectural History
Alpin KÖKNEL YENER, Ph.D. * P	Building Science
Gül KOÇLAR ORAL, Ph.D. * P	Building Science
Oğuz MÜFTÜOĞLU, Ph.D. *	Restoration
Ahsen ÖZSOY, Ph.D. * P	Architectural Design
A. Şule ÖZÜEKREN, Ph.D. * P	Building Science
Gülçin PULAT GÖKMEN, Ph.D. * P	Architectural Design
Gülsün SAĞLAMER, Ph.D. * P	Architectural Design
N. Turgut SANER, Ph.D. * P	Architectural History
Ayşe ŞENTÜRER, Ph.D. * P	Architectural Design
Sinan Mert ŞENER, Ph.D. * P	Architectural Design
Leyla TANAÇAN, Ph.D. * P	Building Science
Necdet TORUNBALCI, Ph.D. *	Building Science
Ayşe Nil TÜRKERİ, Ph.D. * P	Building Science
Belkıs ULUOĞLU, Ph.D. * P	Architectural Design
Alper ÜNLÜ, Ph.D. * P	Architectural Design
Zerrin YILMAZ, Ph.D. * P	Building Science
Sevtap YILMAZ DEMİRKALE, Ph.D. * P	Building Science
Yurdanur YÜKSEL DÜLGEROĞLU, Ph.D. * P	Architectural Design
Ferhan YÜREKLİ, Ph.D. * P	Architectural Design
Associate Professors	
Emrah ACAR, Ph.D. * P	Building Science
Aygül AĞIR, Ph.D. * P	Architectural History
Murat AYGÜN, Ph.D. * P	Building Science
İpek AKPINAR, Ph.D. P	Architectural Design
Nezih AYIRAN, Ph.D. * P	Architectural Design
Murat ÇIRACI, Ph.D. * P	Building Science
Aytanga DENER, Ph.D. P	Architectural Design

Pelin DURSUN, Ph.D. ^P	Architectural Design
Fatma ERKÖK, Ph.D. ^P	Architectural Design
Yegan KAHYA, Ph.D. * ^P	Restoration
Hüseyin Lütü KAHVECİOĞLU, Ph.D. ^P	Architectural Design
Mustafa Erkan KARAGÜLER, Ph.D. *	Building Science
Zeynep KUBAN, Ph.D. *	Architectural History
Hülya KUŞ, Ph.D. * ^P	Building Science
Deniz MAZLUM, Ph.D. * ^P	Restoration
Mine ÖZKAR Ph.D. * ^P	Architectural Design
Nurbin PAKER KAHVECİOĞLU, Ph.D. * ^P	Architectural Design
Begüm SERTYEŞİLİŞİK Ph.D. ^P	Building Science
Elçin TAŞ, Ph.D. * ^P	Building Science
Aslıhan ÜNLÜ TAVİL, Ph.D. * ^P	Building Science
Hakan YAMAN, Ph.D. ^P	Building Science
Vedia İpek YÜREKLİ İNCEOĞLU, Ph.D. ^P	Architectural Design
Assistant Professors	
Meltem AKSOY, Ph.D. ^P	Architectural Design
Cem ALTUN, Ph.D. ^P	Building Science
Yasemin ALKIŞER, Ph.D. ^P	Architectural Design
Hülya ARI, Ph.D. ^P	Architectural Design
Ahmet BULUT, Ph.D. ^P	Architectural Design
H. Almıla BÜYÜKTAŞKIN, Ph.D.	Building Science
İkbal ÇETİNEL, Ph.D. ^P	Building Science
Yüksel DEMİR, Ph.D. ^P	Architectural Design
N. Ömer EREM, Ph.D. ^P	Architectural Design
Göksenin İNALHAN, Ph.D. ^P	Architectural Design
Zeynep ERES Ph.D. ^P	Restoration
Gülten MANİOĞLU, Ph.D. ^P	Building Science
Luca ORLANDI Ph.D. ^P	Architectural History
Ozan Önder ÖZENER Ph.D. ^P	Architectural Design
Sakine Yıldız SALMAN, Ph.D. ^P	Restoration
Funda SÖNMEZ, Ph.D. ^P	Architectural Design
S. Aslıhan ŞENEL Ph.D. ^P	Architectural Design
Elmira Ayşe GÜR, Ph.D. ^P	Architectural Design
Nurgün TAMER BEYAZIT, Ph.D. ^P	Building Science
Gülsün TANYELİ, Ph.D. ^P	Restoration
Cemile TİFTİK, Ph.D. ^P	Architectural Design
Cenk ÜSTÜNDAĞ, Ph.D.	Building Science
Dilek YILDIZ, Ph.D. ^P	Architectural Design
Instructors	
Ş. Filiz AKŞİT, Ph.D. ^P	Building Science
Suat APAK Ph.D. ^P	Architectural Design
Deniz ASLAN Ph.D. ^P	Architectural Design
V. Gül CEPHANECİGİL Ph.D. ^P	Architectural History
Çiğdem EREN DEMİREL Ph.D. ^P	Architectural Design
Elif Sezen YAĞMUR KİLİMCİ Ph.D. ^P	Architectural Design
Sait Ali KÖKNAR Ph.D. ^P	Architectural Design
Haluk SESİGÜR, Ph.D.	Building Science
Hakan TONG, Ph.D. ^P	Architectural Design

Gülfer TOPÇU ORAZ, Ph.D. ^P	Building Science
Gökhan ÜLKEN, Ph.D. ^P	Architectural Design
Nilüfer YÖNEY Ph.D ^P	Restoration
Atilla AYDOĞDU	Network administrator
Oruç ÇAKMAKLI ^P	Architectural Design
Specialist	
Aras NEFTÇİ, Ph.D. ^P	Architectural History
Gültekin PULAT	Network administrator
Research Assistants	
Seden ACUN ÖZGÜNLER, Ph.D. ^P	Building Science
Gülseren EROL Ph.D	Building Science
F. Ecem EDİS, Ph.D. ^P	Building Science
A. İrem FALAY Ph.D ^P	Architectural Design
Caner GÖÇER, Ph.D. ^P	Building Science
Y. Hanifi GEDİK Ph.D.	Building Science
Ela ÖNEY YAZICI Ph.D ^P	Building Science
Nuri SERTESER, Ph.D. ^P	Building Science
Fatih SÜTÇÜ, Ph.D.	Building Science
M. Serkan YATAĞAN Ph.D.:	Building Science
Özlem BERBER Ph.D. ^P	Architectural Design
Umut ALMAÇ Ph.D.	Restoration
Bilge AR ^P	Architectural History
Mine AŞÇIĞİL ^P	Building Science
Zeynep ATAŞ ^P	Architectural Design
H. Ozan AVCI ^P	Architectural Design
Zeynep AYDEMİR ^P	Architectural Design
Kevser COŞKUN ^P	Building Science
Ayşe Ceren BILGE ^P	Restoration
Aslı ÇEKMİŞ ^P	Architectural Design
Gül Neşe DOĞUSAN ^P	Architectural History
Neşe GANIÇ ^P	Building Science
Dila GÖKALP ^P	Architectural Design
Önen GÜNÖZ ^P	Architectural Design
İlgi HACIHASANOĞLU ^P	Architectural Design
F. Pınar IRLAYICI ^P	Building Science
Bahriye İLHAN ^P	Building Science
Özgür Esra KAHVECİ ^P	Architectural Design
Mustafa Çağhan KESKİN ^P	Architectural History
Burçin KÜRTÜNCÜ ^P	Architectural Design
Buket METİN ^P	Building Science
Zeren ÖNSEL ATALA ^P	Restoration
Sinan ÖZGEN ^P	Architectural Design
Mustafa Kaan SAĞ ^P	Architectural History
Ahu SÖKMENOĞLU ^P	Architectural Design
N. Onur SÖNMEZ ^P	Architectural Design
Mehmet Emin ŞALGAMCIOĞLU ^P	Architectural Design
Feride ŞENER ^P	Building Science
Hakan Tüzün ŞENGÜN ^P	Architectural Design
Şebnem ŞOHER ^P	Architectural Design

Sevgi TÜRKKAN ^P	Architectural Design
Fatih YAZICIOĞLU ^P	Building Science
Bihter YILMAZ ALMAÇ ^P	Architectural Design